

**1 FIRE SPRINKLER RISER DIAGRAM W/ REMOTE FDC**  
Scale: 12" = 1'-0"

FIRE PROTECTION ABBREVIATIONS			
AG	ABOVE GRADE	FT	FOOT (FEET)
ADD	ADDENDUM	GAL	GALLON
ADDL	ADDITIONAL	GC	GENERAL CONTRACTOR
ADJ	ADJUSTABLE	GPM	GALLONS PER MINUTE
AFF	ABOVE FINISH FLOOR	MC	MECHANICAL CONTRACTOR
AFG	ABOVE FINISH GRADE	MECH	MECHANICAL
ALT	ALTERNATE	MIN	MINIMUM
BG	BELOW GRADE	NTS	NOT TO SCALE
CI	CAST IRON	PC	PLUMBING CONTRACTOR
COL	COLUMN	PLBG	PLUMBING
CW	COLD WATER	QTY	QUANTITY
DN	DOWN	SCH	SCHEDULE
EC	ELECTRICAL CONTRACTOR	SPEC	SPECIFICATIONS
FD	FLOOR DRAIN	SS	STAINLESS STEEL
FDC	FIRE DEPARTMENT CONNECTION	TEMP	TEMPERATURE
FLR	FLOOR	TYP	TYPICAL
FP	FIRE PROTECTION	W	WITH

FIRE PROTECTION SYMBOL LEGEND	
	SHUTOFF VALVE
	CHECK VALVE
	DOUBLE CHECK VALVE
	END CAP
	FIRE DEPARTMENT CONNECTION (FDC)
	BELL

FIRE PROTECTION PIPING LINETYPES	
LINETYPE	DESCRIPTION
	NEW - ABOVE GRADE
	NEW - BELOW GRADE

- FIRE PROTECTION GENERAL NOTES**
- CONTRACTOR SHALL PROVIDE DESIGN FOR SPRINKLER SYSTEMS FOR EXISTING BUILDING TO BE REMODELED.
  - COORDINATE INSTALLATION OF SPRINKLER PIPING AND ALL COMPONENTS WITH OTHER TRADES, OWNER AND GENERAL CONTRACTOR.
  - FIRE PROTECTION SYSTEM TO COMPLY WITH NFPA 13, INSURANCE CARRIER AND ALL APPLICABLE STATE AND LOCAL CODES.
  - CUTTING OF STRUCTURAL AND/OR ARCHITECTURAL MEMBERS TO BE DONE ONLY WITH THE WRITTEN APPROVAL OF THE ARCHITECT AND STRUCTURAL ENGINEER.
  - PROVIDE MINIMUM 10 PSI SAFETY FACTOR.
  - WORKING DRAWINGS INDICATING SPRINKLER HEAD LOCATIONS AND EXPOSED AND CONCEALED PIPING ROUTING SHALL BE PROVIDED TO THE ARCHITECT/ENGINEER PRIOR TO INSTALLATION FOR APPROVAL.
  - FIRE PROTECTION CONTRACTOR IS RESPONSIBLE FOR ORGANIZING A COORDINATION MEETING WITH OTHER TRADES AND OWNER PRIOR TO INSTALLATION.
  - SYSTEM PIPING LOCATION: WET SYSTEM PIPING SHALL BE INSTALLED AT HIGHEST ELEVATION POSSIBLE. PIPING SHALL BE INSTALLED ABOVE ALL MECHANICAL EQUIPMENT, DUCTWORK, AND ALL PLUMBING SYSTEM PIPING. PROVIDE ADEQUATE CLEARANCE TO MECHANICAL UNITS. FIRE PROTECTION CONTRACTOR SHALL COORDINATE FIRE PROTECTION PIPING PRIOR TO INSTALLATION.
  - PROPERLY TORQUE MECHANICAL TEES TO MANUFACTURER'S RECOMMENDATIONS.
  - FIRE PROTECTION PLANS ARE FOR REFERENCE ONLY. OCCUPANCIES AND AREA OF PROTECTION NOTED ON THE PLANS SHALL BE CONFIRMED WITH NFPA 13 AND AUTHORITIES HAVING JURISDICTION. THIS CONTRACTOR SHALL COMPLY WITH ANY CODE REQUIREMENTS.
  - REFER TO ARCHITECTURAL FIRE CODE PLAN FOR ADDITIONAL INFORMATION.

FIRE PROTECTION SHEET INDEX	
F000	FIRE PROTECTION TITLE SHEET
F101	FIRE PROTECTION PLAN - FIRST FLOOR
F102	FIRE PROTECTION PLAN - SECOND FLOOR

**AGP**  
the Abila Griffin  
Partnership L.L.C.

313 S. E. 5th Street  
MOORE, OK. 73160  
405.735.3477  
AGP@theAGP.net  
www.theAGP.net

CEDAR CREEK  
CIVIL

KFC ENGINEERING  
STRUCTURAL

SALAS O'BRIEN  
MECHANICAL / ELECTRICAL

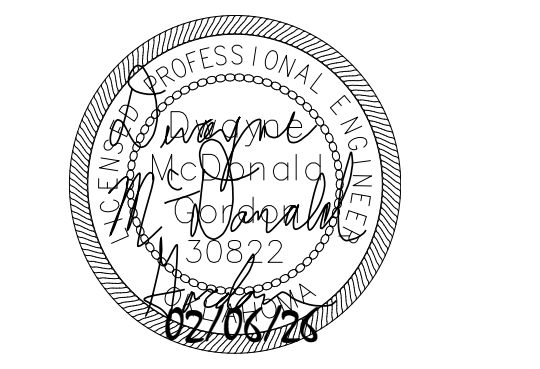

KS  
drawn by

KP  
checked by

FEBRUARY 2026  
date

REVISIONS

Δ	DESCRIPTION	DATE

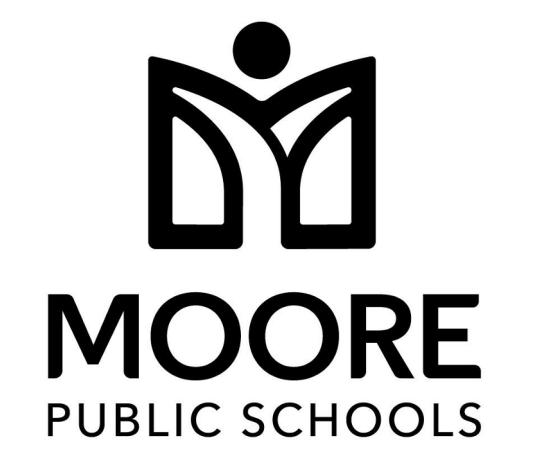

OLD SCHOOL  
REPLACEMENT

sheet no:  
**F000**

**Salas O'Brien**

Oklahoma City  
2900 S. Telephone Road, suite 120  
Moore, OK 73160  
CA# 7058 Expiration Date: 06/30/27  
Salas O'Brien Project Number: 2550-01554-00

OWNERSHIP USE OF DOCUMENTS:  
AGP EXPRESSLY RESERVES ITS COPYRIGHT AND OTHER PROPERTY RIGHTS OF ALL PLANS AND DRAWINGS DESIGNED AND/OR PRODUCED. PLANS AND DRAWINGS ARE NOT TO BE REPRODUCED IN ANY FORM OR MANNER WITHOUT THE EXPRESSED WRITTEN CONSENT OF AGP.



KS  
drawn by  
KP  
checked by  
FEBRUARY 2026  
date

REVISIONS

Δ	DESCRIPTION	DATE

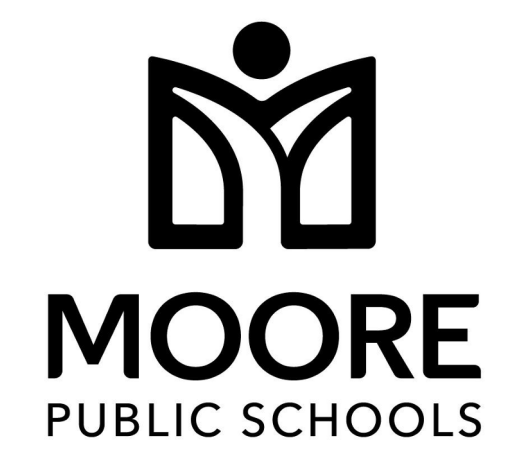

OLD SCHOOL  
REPLACEMENT

sheet no:

## F101

OWNERSHIP USE OF DOCUMENTS:  
AGP EXPRESSLY RESERVES ITS  
COPYRIGHT AND OTHER PROPERTY  
RIGHTS OF ALL PLANS AND DRAWINGS  
DESIGNED AND/OR PRODUCED. PLANS  
AND DRAWINGS ARE NOT TO BE  
REPRODUCED IN ANY FORM OR MANNER  
WITHOUT THE EXPRESSED WRITTEN  
CONSENT OF AGP.

### GENERAL NOTES

- COORDINATE WORK WITH ALL OTHER TRADES ON SITE.
- REFER TO GENERAL NOTES ON SHEET F000.
- COORDINATE FIRE DEPARTMENT CONNECTION LOCATIONS WITH LOCAL FIRE DEPARTMENT OR AHJ.
- FIELD VERIFY EXISTING CONDITIONS PRIOR TO COMMENCING WORK.
- REFER TO ARCHITECTURAL PLANS FOR CEILING TYPE AND HEIGHTS.
- SEMI-RECESSED PENDANT SPRINKLER HEADS IN LAY-IN AND HARD CEILINGS SHALL HAVE WHITE FINISH. EXPOSED UPRIGHT HEADS SHALL BE BRASS WITH WIRE GUARDS.
- FIRE SEAL ALL PENETRATIONS THRU RATED STRUCTURES TO MAINTAIN FIRE RATING.
- COORDINATE INSPECTORS TEST DRAIN LOCATION WITH ALL TRADES ON SITE.
- CONTRACTOR SHALL COORDINATE ALL STORM SHELTER WALL AND ROOF PENETRATIONS WITH STRUCTURAL. REFER TO STRUCTURAL DETAIL SHEET FOR PENETRATION PROTECTION FOR RECTANGULAR OPENINGS GREATER THAN 3.5 SQUARE INCHES AND CIRCULAR OPENINGS GREATER THAN 2.125 INCHES PER 2014 ICC-500.

### KEYED NOTES

- |   |   |
|---|---|
| 1 | LIGHT HAZARD - REFER TO ARCHITECTURAL PLANS FOR CEILING HEIGHT AND TYPE.                            |
| 2 | ORDINARY HAZARD GROUP 1 - REFER TO ARCHITECTURAL PLANS FOR CEILING HEIGHT AND TYPE.                 |
| 3 | LIGHT HAZARD - SAFEROOM AREA - REFER TO ARCHITECTURAL PLANS FOR CEILING HEIGHT AND TYPE.            |
| 4 | ORDINARY HAZARD GROUP 1 - SAFEROOM AREA - REFER TO ARCHITECTURAL PLANS FOR CEILING HEIGHT AND TYPE. |
| 5 | PROVIDE DRY TYPE SPRINKLER HEAD FOR COOLER OR FREEZER. COORDINATE TYPE WITH ENCLOSURE MANUFACTURER. |

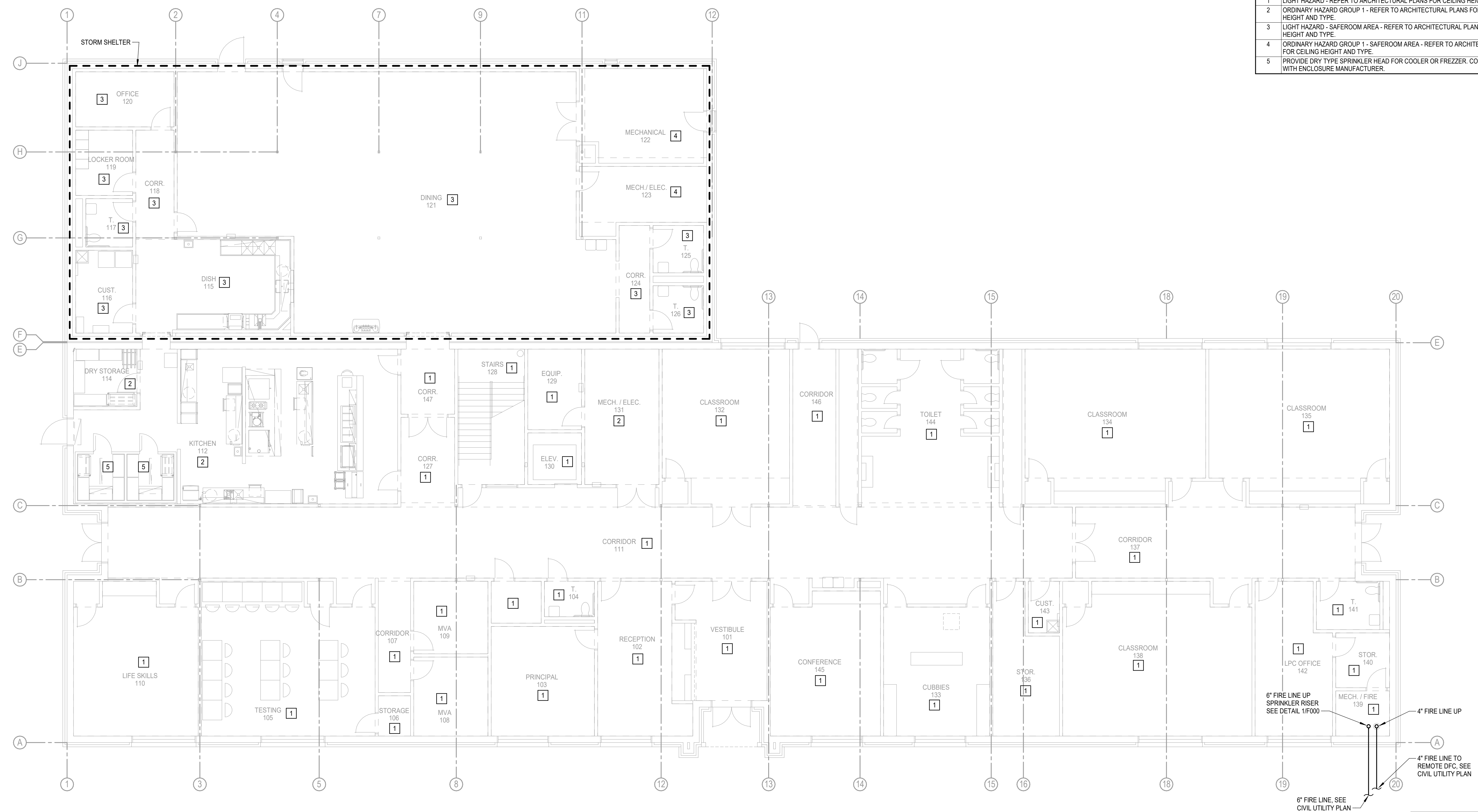

**1 FIRE PROTECTION PLAN - FIRST FLOOR**  
Scale: 1/8" = 1'-0"

**Salas O'Brien**  
Oklahoma City  
2900 S. Telephone Road, suite 120  
Moore, OK 73160  
CA# 7058 Expiration Date: 06/30/27  
Salas O'Brien Project Number: 2550-01554-00



- GENERAL NOTES**
- COORDINATE WORK WITH ALL OTHER TRADES ON SITE.
  - REFER TO GENERAL NOTES ON SHEET F000.
  - COORDINATE FIRE DEPARTMENT CONNECTION LOCATIONS WITH LOCAL FIRE DEPARTMENT OR AHJ.
  - FIELD VERIFY EXISTING CONDITIONS PRIOR TO COMMENCING WORK.
  - REFER TO ARCHITECTURAL PLANS FOR CEILING TYPE AND HEIGHTS.
  - SEMI-RECESSED PENDANT SPRINKLER HEADS IN LAY-IN AND HARD CEILINGS SHALL HAVE WHITE FINISH. EXPOSED UPRIGHT HEADS SHALL BE BRASS WITH WIRE GUARDS.
  - FIRE SEAL ALL PENETRATIONS THRU RATED STRUCTURES TO MAINTAIN FIRE RATING.
  - COORDINATE INSPECTORS TEST DRAIN LOCATION WITH ALL TRADES ON SITE.
  - CONTRACTOR SHALL COORDINATE ALL STORM SHELTER WALL AND ROOF PENETRATIONS WITH STRUCTURAL. REFER TO STRUCTURAL DETAIL SHEET FOR PENETRATION PROTECTION FOR RECTANGULAR OPENINGS GREATER THAN 3.5 SQUARE INCHES AND CIRCULAR OPENINGS GREATER THAN 2.125 INCHES PER 2014 ICC-500.

- KEYED NOTES**
- |   |  |
|---|--|
| 1 | LIGHT HAZARD - REFER TO ARCHITECTURAL PLANS FOR CEILING HEIGHT AND TYPE.   |
| 2 | LIGHT HAZARD - IT ROOM - PROVIDE INTERMEDIATE TEMPERATURE TYPE HEADS. COORDINATE HEAD LOCATION WITH IT DEPARTMENT. |
| 3 | ORDINARY HAZARD GROUP 1 - REFER TO ARCHITECTURAL PLANS FOR CEILING HEIGHT AND TYPE.                                |

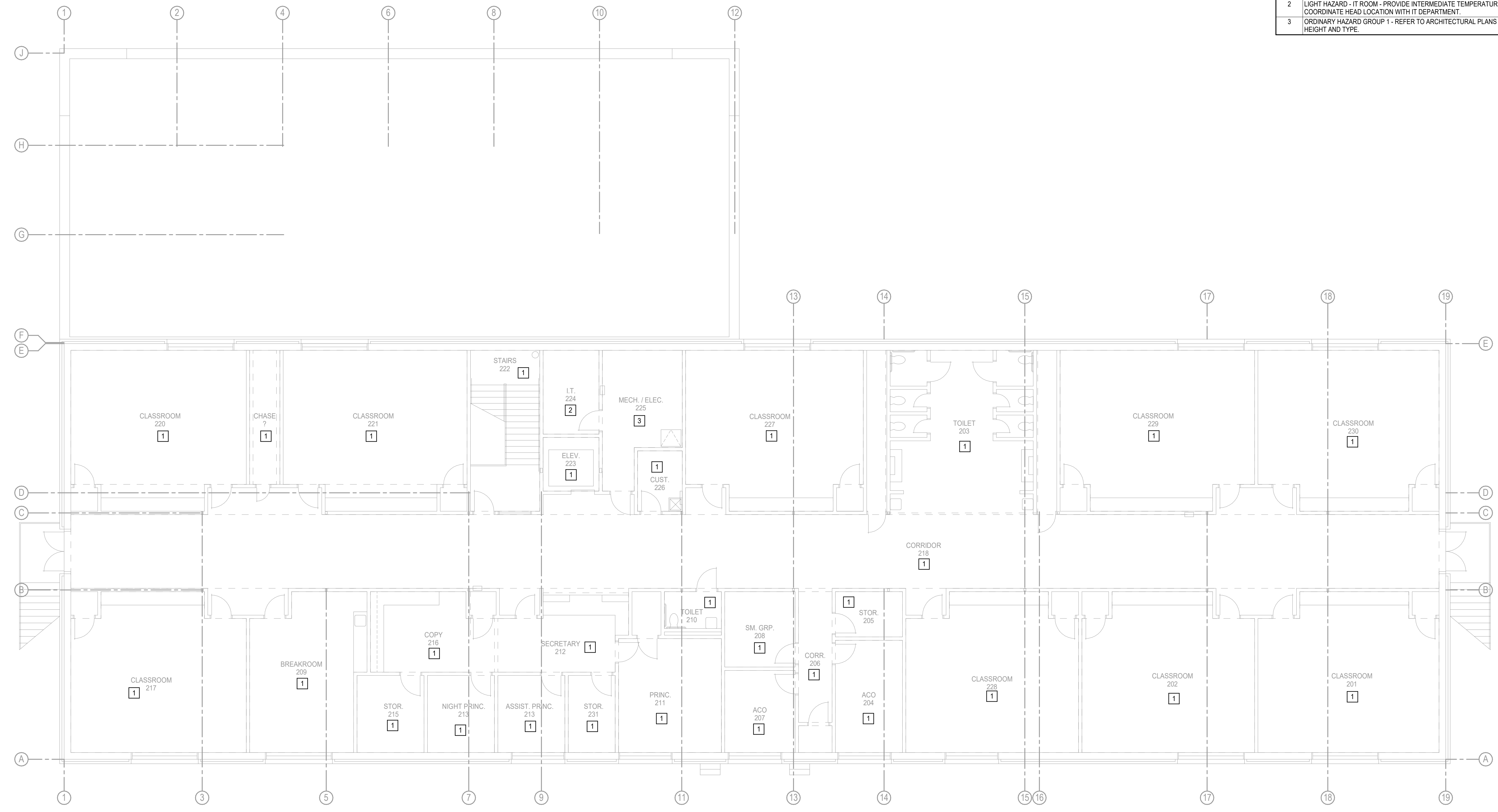

**FIRE PROTECTION PLAN - SECOND FLOOR**  
Scale: 1/8" = 1'-0"

KS  
drawn by  
KP  
checked by  
FEBRUARY 2026  
date

REVISIONS

Δ	DESCRIPTION	DATE



OLD SCHOOL  
REPLACEMENT

sheet no:

**F102**

**Salas O'Brien**  
Oklahoma City  
2900 S. Telephone Road, suite 120  
Moore, OK 73160  
CA# 7058 Expiration Date: 06/30/27  
Salas O'Brien Project Number: 2550-01554-00

OWNERSHIP USE OF DOCUMENTS:  
AGP EXPRESSLY RESERVES ITS COPYRIGHT AND OTHER PROPERTY RIGHTS OF ALL PLANS AND DRAWINGS DESIGNED AND/OR PRODUCED. PLANS AND DRAWINGS ARE NOT TO BE REPRODUCED IN ANY FORM OR MANNER WITHOUT THE EXPRESSED WRITTEN CONSENT OF AGP.